

## Håndvinsj til SKY Lysmast – type DELTA 1200

### Bruksanvisning (engelsk)

#### **WARNING**

1. Do not load winch beyond its rated capacity. Capacity rating is based on one layer of line around the drum. As line builds on drum, capacity decreases. Obtain cable and rope manufactures recommendation for size and type.
2. Do not use winch for lifting people or loads over people.
3. Learn to use your winch. After installing your winch, take the time to practice using it so that you are comfortable with it when the need arises. Periodically, check the winch installation to assure that all bolts are tight.
4. If used as a vehicle winch, do not “move” your vehicle to assist the winch. The combination of the winch and vehicle pulling together could overload the cable.
5. Keep winch area clear. Do not allow people to remain in the winch area. Do not stand between the winch and the load.
6. Inspect cable frequently. A frayed cable or rope with broken strands should be replaced immediately. Do not operate winch if line is kinked, or shows any signs of corrosion, or weakness.
7. Keep hands and fingers clear of the winch and cable when using the winch.
8. Always check for correct direction of rotation before using the winch.
9. Do not hold a load on a trailer with winch cable. Tie down ropes or straps must be used to secure a load to trailer.
10. Never hook the cable back onto itself, use a sling. Hooking the cable onto itself creates an unacceptable strain on the cable. (See Fig. A)
11. It is a good idea to lay a heavy blanket or jacket over the cable about 15 feet from the hook end when pulling in severe condition. If a cable failure should occur, the weight of the cloth will act as a damper and prevent broken cable from whipping.
12. Avoid pulls from extreme angles. This may damage the cable and winch drum.
13. Never install winch in such a way that the warning and direction labels are obscured. Someone who has not read this manual may need to see them to understand the proper operation of the winch.
14. Do not attach winch to objects of unknown carrying capacity which may cause it to break loose during operation.
15. Operate winch by hand power only.
16. Always keep a minimum of four coils of cable on the drum for safe operation. This will supply friction for a proper anchor; otherwise the cable or rope may pull loose from the drum.
17. Failure to comply with all of these warnings may cause serious injury and/ or damage to property.

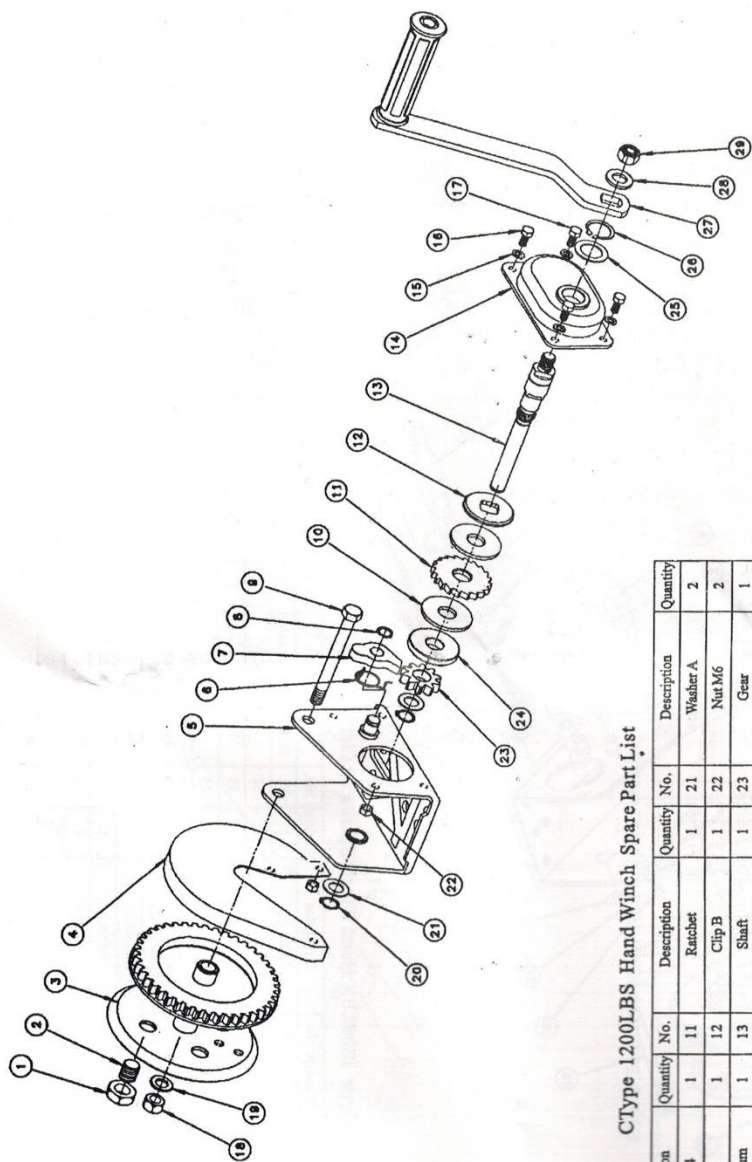

CTtype 1200LBS Hand Winch Spare Part List

No.	Description	Quantity	No.	Description	Quantity	No.	Description	Quantity
1	Nut M14	1	11	Ratchet	1	21	Washer A	2
2	Screw	1	12	Clip B	1	22	Nut M6	2
3	Twine Drum	1	13	Shaft	1	23	Gear	1
4	Cover	1	14	Cover Part	1	24	Clip A	1
5	Mounted Base	1	15	Washer 6	4	25	Washer B	1
6	Snap Ring	1	16	Bolt M6x16	2	26	Retaining Ring for Axle 20	1
7	Ratchet Claw	1	17	Bolt M6x10	2	27	Rocher Arm	1
8	Retaining Ring for Axle 12	1	18	Nut M10	1	28	Washer 12	1
9	Bolt M10x100	1	19	Washer 10	1	29	Nut M12	1
10	Friction Flake	2	20	Retaining Ring for Axle 13	2	30		

Samsvarserklæring



AFLEID TEST CERTIFICAAT  
&  
CE CONFORMITEITSVERKLARING

DERIVED CERTIFICATE OF TEST  
&  
DECLARATION OF CE CONFORMITY

Hiermede verklaren wij dat het hieronder vermeld product zorgvuldig geïnspecteerd en beproefd is en dat de volgende beproevings- en inspectiegegevens overeenstemmen met de specificaties van ons technisch dossier.

*This is to certify that the undermentioned product has been thoroughly inspected and tested and that the following data of inspection and test is in conformity with the requirements of our technical file.*

Omschrijving : Delta galvanized manual winch 550 Kg : Description

Model : DS.0.BHW.1200 : Type

Serie nummer: S150492 up to S150500 : Serial number

Max. veilige belasting : 0,550 ton : Safe Working Load S.W.L.

Minimum breeklast: 2,200 ton : Test load

Wij verklaren dat het bovengenoemde product in overeenstemming is met de veiligheidsfactor en overige veiligheidseisen van de Europese Machineryrichtlijn 2006/42/EC.

*We declare that the above-mentioned product is in compliance with the safety factor and further safety requirements in conformity with the European Communities Machinery Directive 2006/42/EC.*

Handtekening : M.F. STAM  
Signed by :

Functie : Directeur  
Position :

Datum : 25-08-2015  
Date:

Factuur nummer: 70300  
Invoice no.



DELTA® - DELTA BLUE® - DELTA CLAMP® - DELTA CONTROL® - DELTA FOR® - DELTA GREEN® -  
DELTA KARWEILIER® - DELTA KARWEITAKEL® - DELTA SILVER® - DELTA SLING® - DELTA SPARKLESS® -  
PROF KARWEI® - DELTA LOCK® - MAVERICK® - DELTA YELLOW® zijn geregisteerde merken en eigendom van STAM BOUWMACHINES® bv. Adres: Uiterdijk 7, 1505 GW Zaandam, Nederland.

08.07.2016